



# Fire Starter

Model: FS001

---

## User Guide

---

### Instructions for use:

1. Fill the Flaming Coals Fire Starter to the rim with charcoal or BBQ beads.
2. Light 3 firelighter cubes in the base of your BBQ or spit roaster and light.
3. Place the Flaming Coals Fire Starter directly over the burning firelighters.
4. In approximately 25 minutes, the colour of your coals will have gone grey and are ready to use. Carefully pour the coals from the Flaming Coals Fire Starter into your BBQ or spit roaster.



### Features:

1. The heat shield provides protection from the heat of the hot coals when pouring the contents into your BBQ or spit roaster.
2. The wooden handle does not insulate the heat so your hand is always protected
3. Large holes at the bottom of the unit allow maximum airflow to ensure reduced lighting time.

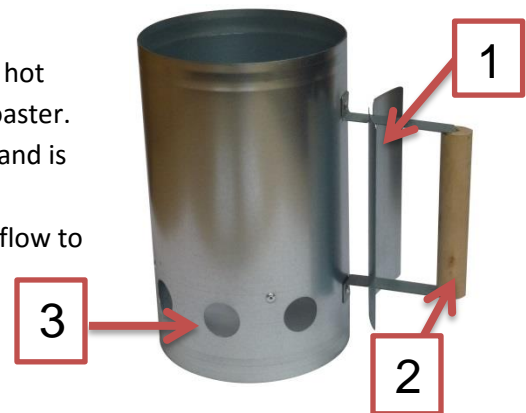

**Warning:** The Flaming Coals Fire Starter is for outdoor use only. For safety reasons, only use firelighter cubes to start the fire. Do not use liquid fire starter, alcohol etc. The Flaming Coals Fire Starter gets very hot. You should wear protective clothing when handling hot coals and ensure you keep children and pets away from the unit.



# Fire Starter

Model: FS001

---

## User Guide

---

### Instructions for use:

5. Fill the Flaming Coals Fire Starter to the rim with charcoal or BBQ beads.
6. Light 3 firelighter cubes in the base of your BBQ or spit roaster and light.
7. Place the Flaming Coals Fire Starter directly over the burning firelighters.
8. In approximately 25 minutes, the colour of your coals will have gone grey and are ready to use. Carefully pour the coals from the Flaming Coals Fire Starter into your BBQ or spit roaster.



### Features:

4. The heat shield provides protection from the heat of the hot coals when pouring the contents into your BBQ or spit roaster.
5. The wooden handle does not insulate the heat so your hand is always protected
6. Large holes at the bottom of the unit allow maximum airflow to ensure reduced lighting time.

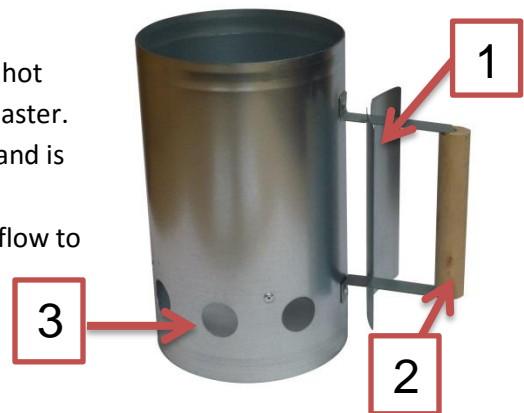

**Warning:** The Flaming Coals Fire Starter is for outdoor use only. For safety reasons, only use firelighter cubes to start the fire. Do not use liquid fire starter, alcohol etc. The Flaming Coals Fire Starter gets very hot. You should wear protective clothing when handling hot coals and ensure you keep children and pets away from the unit.